

## LIMITED WARRANTY REGISTRATION CARD

Please present your Warranty Card and a copy of your original sales receipt to validate warranty coverage. DO NOT lose your receipt. Please review the terms & conditions of ChoiceMMed America Co.'s Warranty.

To obtain full warranty coverage, this card must be completed, signed and returned to ChoiceMMed America Co. within 30 days from date of purchase. Failure to register this card within 30 days may render the warranty null & void.

RETURN ADDRESS: ChoiceMMed America Co. 2558 Pearl Buck Rd, Suite 8A, Bristol, PA 19007

MODEL NO. \_\_\_\_\_ SERIES NO. (SN) \_\_\_\_\_

DESCRIPTION \_\_\_\_\_

PURCHASE DATE \_\_\_\_\_

CUSTOMER NAME (MR.  MRS.  MS.  \_\_\_\_\_

PHONE NUMBER \_\_\_\_\_

MAILING ADDRESS \_\_\_\_\_

CITY/STATE \_\_\_\_\_ ZIP \_\_\_\_\_

For troubleshooting assistance please contact Consumer Support. Our representatives are trained to provide you assistance over the phone and may be able to resolve your problem without returning. For the best possible assistance please have your unit available when calling us.

### Service Phone: (215) 874-0458

Customer Service Representatives are available Monday through Friday - 8:30am to 4:30pm EST

## STATEMENT OF CHOICEMMED AMERICA CO. / LIMITED WARRANTY

ChoiceMMed America Co. warrants to the original purchaser that this equipment will be free from defects in materials and workmanship for a period of two years from the date of purchase. This warranty shall be limited to the repair adjustment and/or replacement at the manufacturer's option of defective parts free of charge except the cost of transportation to ChoiceMMed America Co. Manufacturer's responsibility is limited to actual cost of item. When returning equipment for warranty service, all shipping and insurance charges must be prepaid and the proof of purchase must be enclosed. A payment of \$10.00 must be included to cover the return shipping and handling. Returns will only be shipped to locations within the USA. ChoiceMMed America Co. will not be responsible for expenses or inconveniences, or consequential damages occasioned by equipment or by breach of any expressed or implied warranty with respect thereto.

### Limitations

This warranty covers all defects encountered in normal use of the equipment and does not apply in the following cases.

- 1) If the equipment has been serviced by other than a certified center.
- 2) Damage to the equipment due to mishandling, abuse, accident or not following operating instructions.
- 3) INSTRUMENTS: Warranty does not extend to display face, batteries, carrying case or lanyard.

### ChoiceMMed America Co.

2558 Pearl Buck Rd, Suite 8A, Bristol, PA 19007

# OPERATOR'S MANUAL

## OxyWatch C15D Fingertip Pulse Oximeter

### 1. General Description

Thank you for purchasing OxyWatch C15D pulse oximeter. This oximeter can be used to measure your blood oxygen saturation (in % SpO<sub>2</sub>) and your pulse rate. It should be used for spot monitoring only and not for continuous monitoring.

The OxyWatch C15D Finger-Unit spot check oximeter is only for sports and aviation use. It is ideal for use during sports activities, mountain climbing and piloting airplanes. It is not intended to diagnosis any medical condition or to be used in medical applications.

### 2. Package Contents

1. OxyWatch C15D Pulse Oximeter
2. Lanyard
3. User Manual
4. Carrying Pouch
5. 2 AAA Batteries

### 3. Precautions for Use

1. Read the manual carefully before use.
2. Pulse oximeters are sensitive to motion artifacts. Keep hands still while taking a reading.
3. Pulse oximeters require sufficient blood flow to obtain proper readings. Poor blood circulation can result in inaccurate readings. If your hands are cold or you have poor circulation, warm your hands by rubbing them together or use another method before attempting to obtain a reading. A tourniquet, blood pressure cuff or other blood flow hindrances may also result in inaccurate readings.
4. Fingernail polish or acrylic nails obstruct the light transmission and may also result in inaccurate readings.
5. Your finger must be clean for a proper reading.
6. The pulse oximeter must be clean for a proper reading.
7. If a reading is difficult to obtain, switch to another finger or to the other hand.
8. There are a number of other conditions which may lead to an inaccurate reading including but not limited to recent medical tests that included an injection of dyes, use of arterial catheters, a weak pulse, low levels of hemoglobin in the blood, low perfusion (the quality of your pulse), elevated levels of dysfunctional hemoglobin, the strength and type of light that you are in while using the pulse oximeter and the existence of cell phones, radios, and fixed transmitters within certain ranges of the pulse oximeter during use.
9. The pulse oximeter will not alert you if your readings are out of normal range.
10. Explosion hazard: Do not use the pulse oximeter in an explosive atmosphere.
11. The pulse oximeter has no SpO<sub>2</sub> alarms; it is not for continuous monitoring, as indicated by the symbol.

**In addition to items described in the Precautions for Use, inaccurate measurements may be caused by FACTORS INCLUDING BUT NOT LIMITED TO:**

1. Autoclaving, ethylene oxide sterilizing or immersing the sensors in liquid.
2. Significant levels of dysfunctional hemoglobin (such as carboxy-hemoglobin or methemoglobin).
3. Intravascular dyes such as indocyanine green or methylene blue.
4. SpO<sub>2</sub> measurements may be adversely affected in the presence of high ambient light such as direct sunlight. In bright light conditions, cover the sensor area if necessary.
5. Excessive user movement.
6. High-frequency electrosurgical interference and defibrillators.
7. Venous pulsations.
8. The user has hypotension, severe vasoconstriction, severe anemia or hypothermia.
9. Fingernail polish or false fingernails may cause inaccurate SpO<sub>2</sub> readings.

### 4. Battery Installation

1. Install two AAA batteries into the battery compartment. Match the plus (+) and minus (-) signs in the compartment. If the polarities are not matched, damage may be caused to the oximeter.
2. Slide the battery door cover horizontally along the arrow as shown in the picture.

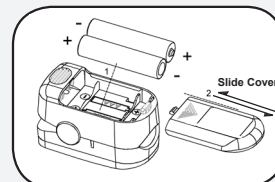

**NOTE:** Install the batteries in right polarity. Incorrect placement may cause damage to the bracket.

**NOTE:** Remove the batteries if the pulse oximeter will not be used for long periods of time.

3. The battery indicator symbol on the front panel display will light when the battery voltage is too low for normal operation of the pulse oximeter. Replace the batteries when indicator symbol lights.

### 5. Using the Oximeter

1. Open the clamp as shown in the picture.
2. Place one of your fingers into the rubber opening of the pulse oximeter (your finger should touch the bottom portion) before releasing the clamp.
3. Press the switch button one time on front panel to turn the pulse oximeter on.
4. Keep your hands still for the reading. Do not shake your finger during the test. It is recommended that you do not move your body while taking a reading.
5. Read the data from the display screen.
6. There are four display modes. After turning on the pulse oximeter, each time you press the power switch, the pulse oximeter will switch to another display mode.
7. When you press the power switch for more than one second, the brightness of the pulse oximeter will be changed by degrees. There are 10 levels of brightness. The default level is level four.
8. When no signal or low signal is detected, the pulse oximeter will power off automatically in 8 seconds.

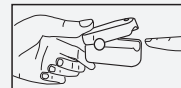

### 6. Maintenance

1. Clean the pulse oximeter and sensor with a soft cloth dampened with isopropyl alcohol. Do not pour or spray any liquids onto the pulse oximeter. Do not allow any liquid to enter any openings in the device. Allow the pulse oximeter to dry thoroughly before reusing. (The rubber inside of the pulse oximeter is composed of medical grade rubber. It is non-toxic and is not harmful to the skin.)
2. The pulse oximeter requires no routine calibration or maintenance other than replacement of the batteries.

### 7. Brief Description of Front Panel

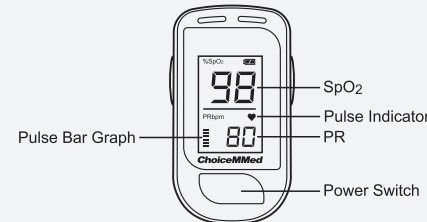

The height of the Pulse Bar graph indicates the intensity of the pulse and signal strength. The bar should be greater than 30% for a proper reading.

### 8. Technical Specifications

1. **Display:** LCD display  
PR display mode: bargraph  
Low power indication:
2. **Battery Standard:** Two AAA 1.5V Alkaline Batteries
3. **Power Consumption:** Less than 40mA
4. **Resolution:** ±1% for SpO<sub>2</sub> and ±1 BPM for Pulse Rate
5. **Measurement Range:** Measuring range for SpO<sub>2</sub>: 70-100%  
Measuring range for PR: 30-250 BPM
6. **Measurement Accuracy:**  
SpO<sub>2</sub>: 70-100%, ±2 digits; <70%, no definition  
PR: 30-99 BPM, ±2 BPM; 100-250 BPM, ±2%
7. **Environment Requirement:**  
Operation Temperature: 5°C~40°C (41°F~104°F)  
Storage Temperature: -20°C~55°C (-4°F~131°F)  
Ambient Humidity: ≤80%, no condensation in operation  
≤93%, no condensation in storage
8. **Automatic Power Off:** The oximeter will power off automatically after 8 seconds when the finger is removed.
9. It is recommended that the product be kept in a dry place. A damp ambient might affect its lifetime and even might damage the product.

### 10. Declaration

EMC of this product complies with IEC60601-1-2 standard  
The materials which users can come into contact with are non-toxic and comply with ISO10993-1, ISO10993-5 and ISO10993-10.

### 9. Possible Problems and Solutions

Problems	Possible reason	Solution
SpO <sub>2</sub> or PR can not be shown normally	1. Finger is not inserted correctly 2. Patient's Oxyhemoglobin value is too low to be measured	1. Retry by inserting the finger 2. Try some more times. If you can make sure no problem exist in the product, please go to a hospital timely for exact diagnosis.
SpO <sub>2</sub> or PR is shown unstably	1. Finger might not be inserted deep enough. 2. Finger is trembling or patient's body is in movement status.	1. Retry by inserting the finger 2. Try not to move
The oximeter can not be powered on	1. Power of batteries might be inadequate or not be there at all. 2. Batteries might be installed incorrectly. 3. The oximeter might be damaged.	1. Please replace batteries 2. Please reinstall the batteries 3. Please contact with local customer service centre
Indication lamps are suddenly off	1. The product is automatically powered off when no signal is detected longer than 8 seconds 2. Power quantity of the batteries is started being inadequate	1. Normal 2. Replace the batteries

## Guidance and manufacturer's declaration – electromagnetic emissions – for all EQUIPMENT and SYSTEMS

Guidance and manufacturer's declaration – electromagnetic environment		
The pulse oximeter is intended for use in the electromagnetic environment specified below. The customer or the user of the pulse oximeter should assure that it is used in such an environment.		
Emission test	Compliance	Electromagnetic environment – guidance
RF emissions CISPR 11	Group 1	The pulse oximeter uses RF energy only for its internal function. Therefore, its RF emissions are very low and are not likely to cause any interference in nearby electronic equipment.
RF emission CISPR 11	Class B	The pulse oximeter is suitable for use in all establishments, including domestic establishments and those directly connected to the public low-voltage power supply network that supplies buildings used for domestic purposes.

### 10. Symbol Definitions

Symbol	Definition
	Oxygen Saturation
	Pulse Rate (bpm)
	Low Power Indication
	Serial Number

### Note:

1. Follow local ordinances and recycling instructions regarding disposal or recycling of the device and device components, including batteries.
2. The illustration used in this manual may differ slightly from the appearance of the actual product.

### Warnings:

1. Keep the pulse oximeter away from young children. Small parts such as the battery door and the batteries, etc., may be hazardous if swallowed.
2. The lanyard may cause strangulation in conditions that may cause it to twist around the neck.

### Distributed by: ChoiceMMed America Co.

US Customer Service Site  
ChoiceMMed America Co.  
2558 Pearl Buck Rd: Suite 8A  
Bristol, PA 19007  
Phone: (215) 874-0458  
www.choicemmedamerica.com

ChoiceMMed America Co.  
© 2013 ALL RIGHTS RESERVED

# Quick Operation Guide

ChoiceMMed\_OxyWatch\_C15D\_Ver1.0

■ Before using the oximeter, please remove protective sticker covering the display.

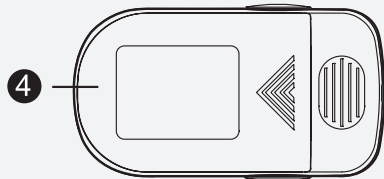
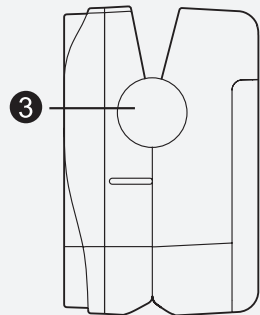
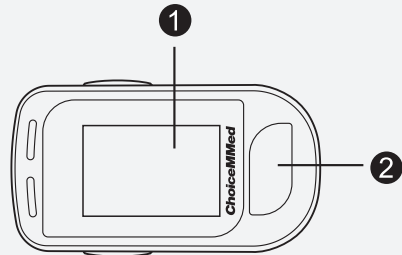

- ① Displaying Screen
- ② Power Key
- ③ Shaft Cover
- ④ Battery Box Cover

## ■ Battery Installation

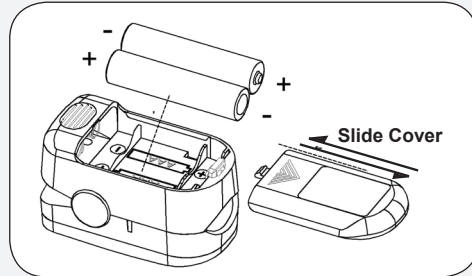

Please put in the batteries according to the polarity marked inside the battery compartment.

## ■ Lanyard Installation

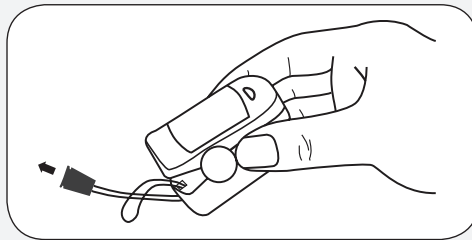

Tie the lanyard through the hole in the rear of the pulse oximeter.

## ■ Operation Instruction

Place one of your fingers into the pulse oximeter to the end and press the switch button one time on front panel to turn it on.

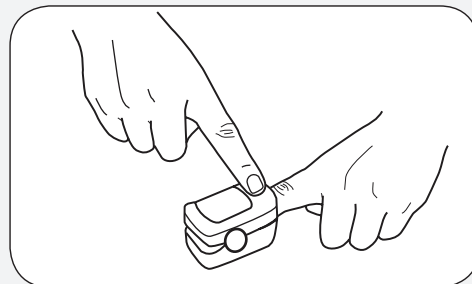

There are two display modes. After turning on the pulse oximeter, each time you press the power switch, the pulse oximeter will switch to another display mode.

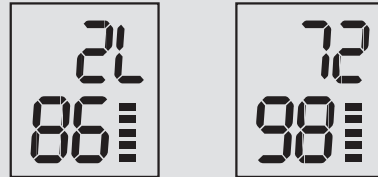

Keep your hands still for the reading.

The pulse oximeter will power off automatically in 8 seconds if there's no finger inside.

## ■ Warnings and Notes

### Warnings:

1. Keep the pulse oximeter away from young children. Small parts such as the battery door and the batteries, etc., may be hazardous if swallowed.
2. The lanyard may cause strangulation in conditions that may cause it to twist around the neck.

### Notes:

1. Read the manual carefully before use.
2. The illustration used in this manual may differ slightly from the appearance of the actual product.
3. Follow local ordinances and recycling instructions regarding disposal or recycling of the device and device components, including batteries.

## What is a Pulse Oximeter?

A pulse oximeter is a non-invasive device that indirectly monitors blood oxygen saturation (SpO<sub>2</sub>) and pulse rate (heart rate). It displays both blood oxygen saturation (SpO<sub>2</sub>) and pulse rate (heart rate). Pulse oximeters provide an easy way of assessing your blood oxygen level and pulse rate.

## What is SpO<sub>2</sub>?

SpO<sub>2</sub> is also known as oxygen saturation. Oxygen saturation is a measure of how much oxygen the blood is carrying as a percentage of the maximum it could carry.

## What is the normal range of SpO<sub>2</sub>?

The normal range for SpO<sub>2</sub> is typically considered from 95%~99%. The SpO<sub>2</sub> measurement may be lower for people who live at high altitudes. Ask your health professional this question as it pertains to you.

## What is the normal range for pulse rate?

The normal resting range for pulse rate is typically considered from 60~100 beats per minute. Ask your health professional this question as it pertains to you.

## What kind of conditions may cause an inaccurate reading?

Cold hands, poor circulation, very weak pulse, movement, fingernail polish and acrylic nails may cause inaccurate results.

## The SpO<sub>2</sub> is not changing – it's stuck?

SpO<sub>2</sub> does not change like pulse rate. It is slow to change.

## The pulse rate is changing rapidly.

Your heart rate changes with emotions, excitement and exercise.

## I do not see the battery light indicator.

The battery light indicator only appears when the battery is low.

**OxyWatch**<sup>TM</sup>